

MARTINDALE

TYPE C COMMSTONE HOLDER INSTRUCTIONS

CAUTION: All Grinder Supports **MUST BE INSULATED** from electrically live circuits and tested for absence of current at the Grinder, before beginning work.

GENERAL:

Do not use the Commstone perpendicular to commutator.

Set commstone at about 30° angle to radial line of commutator, so that when the commstone is worn to face, the commutator will turn toward the **obtuse angle** and **not** toward the **acute** or sharp angle of the commstone.

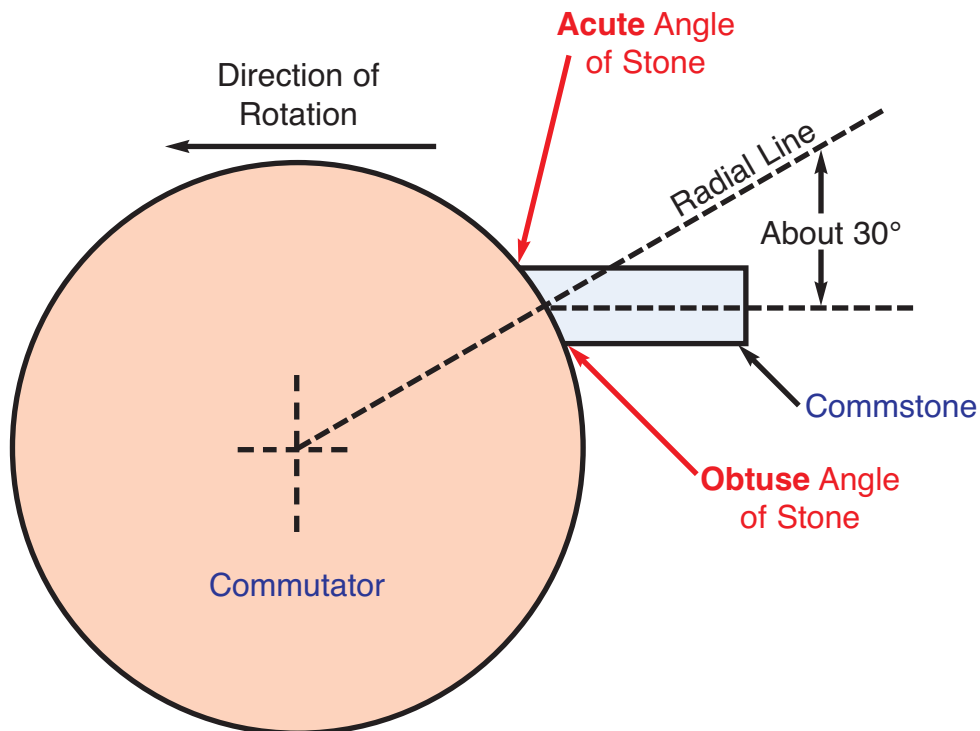

MARTINDALE

Type C Commstone Grinder Parts

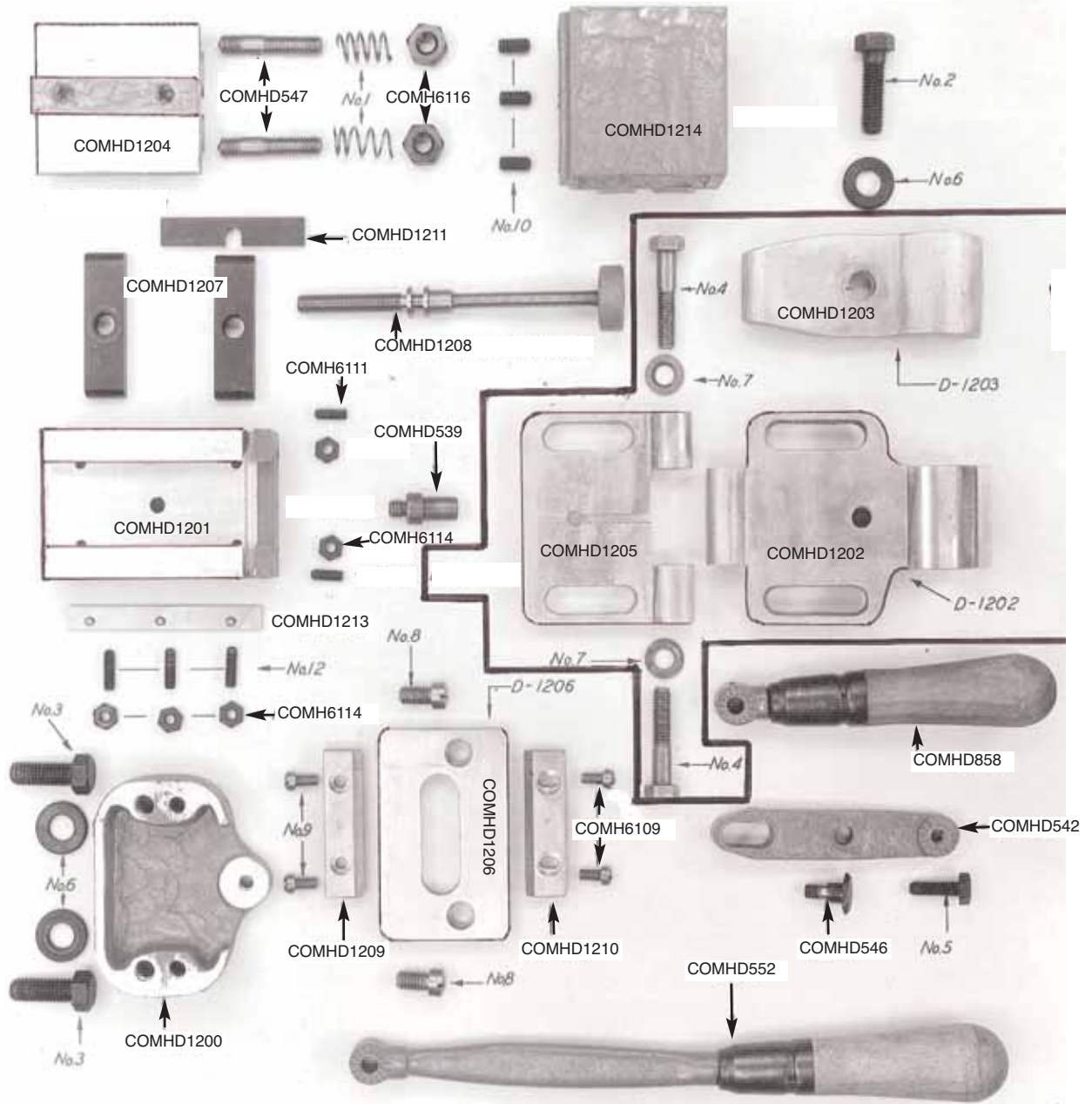

MARTINDALE

Type C Commstone Holder Parts

Quantity	Description	Part No.
2	Spring	COMHH6101
1	Screw, 3/8-16x1-1/4"	
2	Screw, 3/8-16x1"	COMH6113
2	Screw (Opt.), 5/16-18x1-1/2"	
1	Screw, 1/4-20x3/4"	COMH6115
2	Washer, 3/8"	
2	Washer, 5/16"	
2	Screw, 5/16-18x3/4"	
4	Screw, Cap, 10-32x3/8"	COMH6109
3	Screw, Set, 1/4-20x1/2"	
2	Screw, Set, 10-32x3/8"	COMH6111
3	Screw, Set, 10-32x1/2"	
2	Nut, 5/16"-18	COMH6116
5	Nut, 10-32	COMH6114
1	Pin, Slide	COMHD539
1	Lever	COMHD542
1	Screw, Lever Pin	COMHD546
2	Stud	COMHD547
1	Handle, Long	COMHD552
1	Handle, Short	COMHD858
1	Block, Lever Support	COMHD1200
1	Carriage	COMHD1201
1	Adaptor (Optional)	COMHD1202
1	Clamp, Adaptor (Optional)	COMHD1203
1	Holder, Stone	COMHD1204
1	Base, Hinge (Optional)	COMHD1205
1	Plate, "V"	COMHD1206
1	Clamp, Stone	COMHD1207
1	Screw Assembly, Adjusting	COMHD1208
1	Block, "V" (Fixed)	COMHD1209
1	Block, "V" (Adjustable)	COMHD1210
1	Plate, End	COMHD1211
1	Gib	COMHD1213
1	Box, 2"	COMHD1214